

Pennsylvania & Scout

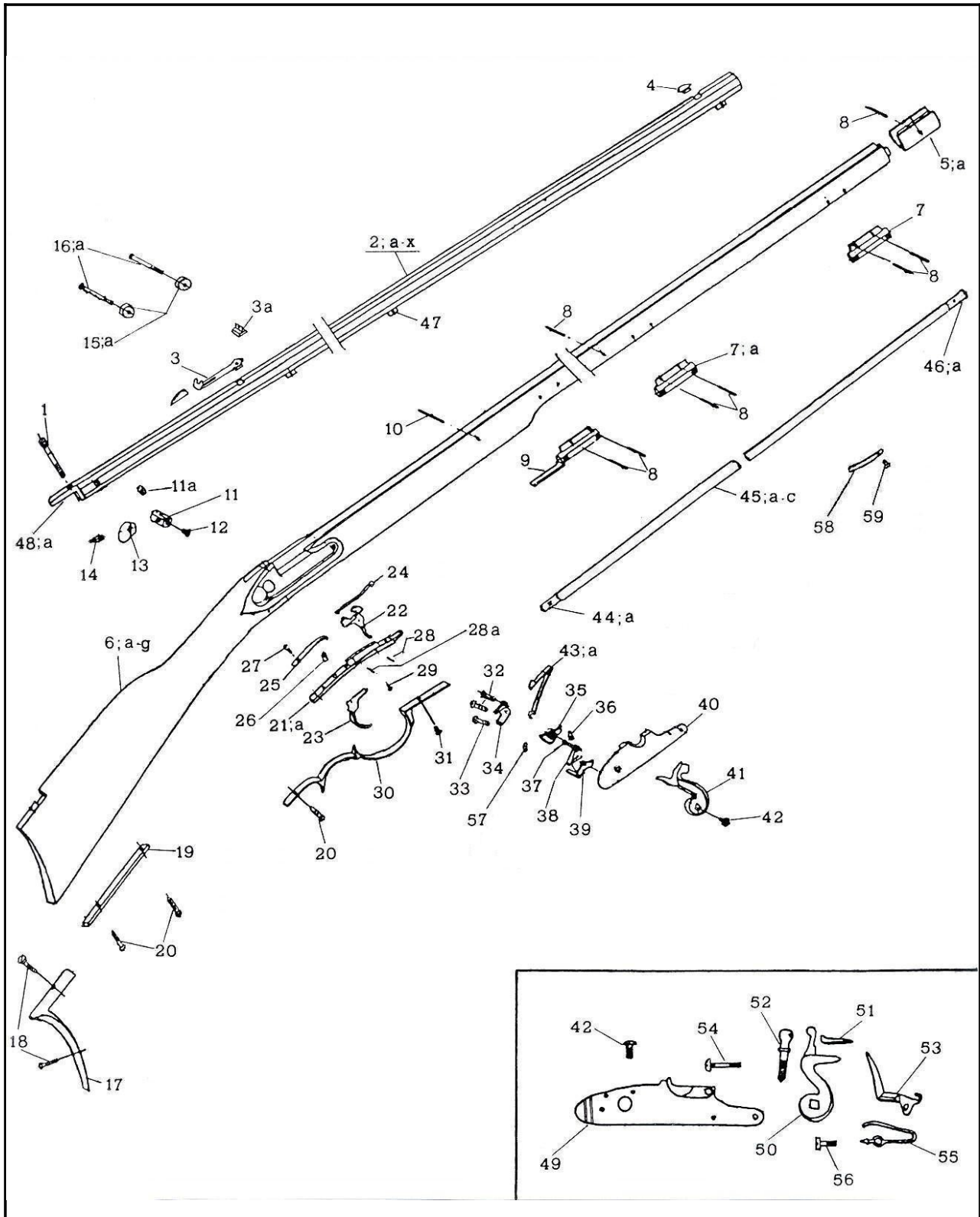

| Nomenclatura / List / Liste | | | | Codice Reference |
|------------------------------------|---|---|---|-------------------------|
| No. | Italiano | English | Français | Référence |
| 1 | Vite codetta | Tang screw | Vis de queue de culasse | M70TFM5550 |
| 2 | Canna cal. .32 | Barrel .32 cal. | Canon Cal 32 | 0800002553 |
| 2a | Canna cal. .45 | Barrel .45 cal. | Canon Cal 45 | 0800002551 |
| 2b | Canna cal. .32 mod. Scout | Barrel .32 cal. for Scout model | Canon Cal 32 pour Scout | 0800002574 |
| 2c | Canna cal. .45 mod. Scout | Barrel .45 cal. for Scout model | Canon Cal 45 pour Scout | 0800002576 |
| 2d | Canna cal. .50 mod. Scout | Barrel .50 cal. for Scout model | Canon Cal 50 pour Scout | 0800002577 |
| 2e | Canna cal. .32 finita (a percussione) | Barrel .32 cal., finished (percussion) | Canon Cal 32 ouvragé (à percussion) | 0800P2553A |
| 2f | Canna cal. .32 finita (a pietra focaia) | Barrel .32 cal., finished (flintlock) | Canon Cal 32 ouvragé (à silex) | 0800F2553A |
| 2g | Canna cal. .45 finita (a percussione) | Barrel .45 cal., finished (percussion) | Canon Cal 45 ouvragé (à percussion) | 0800P2551A |
| 2h | Canna cal. .45 finita (a pietra focaia) | Barrel .45 cal., finished (flintlock) | Canon Cal 45 ouvragé (à silex) | 0800F2551A |
| 2i | Canna Scout cal. .32 finita (a percuss.) | Scout barrel .32 cal., finished (percuss.) | Canon Scout Cal 32 ouvragé (percuss.) | 0800P2574A |
| 2j | Canna Scout cal. .32 finita (a pietra) | Scout barrel .32 cal., finished (flintlock) | Canon Scout Cal 32 ouvragé (à silex) | 0800F2574A |
| 2k | Canna Scout cal. .45 finita (a percuss.) | Scout barrel .45 cal., finished (percuss.) | Canon Scout Cal 45 ouvragé (percuss.) | 0800P2576A |
| 2l | Canna Scout cal. .45 finita (a pietra) | Scout barrel .45 cal., finished (flintlock) | Canon Scout Cal 45 ouvragé (à silex) | 0800F2576A |
| 2m | Canna Scout cal. .50 finita (a percuss.) | Scout barrel .50 cal., finished (percuss.) | Canon Scout Cal 50 ouvragé (percuss.) | 0800P2577A |
| 2n | Canna Scout cal. .50 finita (a pietra) | Scout barrel .50 cal., finished (flintlock) | Canon Scout Cal 50 ouvragé (à silex) | 0800F2577A |
| 2o | Canna cal. .32 completa (a percussione) | Barrel .32 cal. with percussion spares | Canon Cal 32 complet (à percussion) | 0800P2553B |
| 2p | Canna cal. .32 completa (a pietra focaia) | Barrel .32 cal. with flintlock spares | Canon Cal 32 complet (à silex) | 0800F2553B |
| 2q | Canna cal. .45 completa (a percussione) | Barrel .45 cal. with percussion spares | Canon Cal 45 complet (à percussion) | 0800P2551B |
| 2r | Canna cal. .45 completa (a pietra focaia) | Barrel .45 cal. with flintlock spares | Canon Cal 45 complet (à silex) | 0800F2551B |
| 2s | Canna Scout .32 completa (percuss.) | Scout barrel .32 with percussion spares | Canon Scout Cal 32 complet (percuss.) | 0800P2574B |
| 2t | Canna Scout .32 completa (a pietra) | Scout barrel .32 with flintlock spares | Canon Scout Cal 32 complet (à silex) | 0800F2574B |
| 2u | Canna Scout .45 completa (percuss.) | Scout barrel .45 with percussion spares | Canon Scout Cal 45 complet (percuss.) | 0800P2576B |
| 2v | Canna Scout .45 completa (a pietra) | Scout barrel .45 with flintlock spares | Canon Scout Cal 45 complet (à silex) | 0800F2576B |
| 2w | Canna Scout .50 completa (percuss.) | Scout barrel .50 with percussion spares | Canon Scout Cal 50 complet (percuss.) | 0800P2577B |
| 2x | Canna Scout .50 completa (a pietra) | Scout barrel .50 with flintlock spares | Canon Scout Cal 50 complet (à silex) | 0800F2577B |
| 3 | Tacca di mira regolabile | Adjustable rear sight | Hausse | 0800004821 |
| 3a | Tacca di mira fissa | Rear sight | Cran de mire | 0800004803 |
| 4 | Mirino | Front sight | Guidon | 0800003605 |
| 5 | Fascetta canna | Forend cap | Bande du canon | 0800002904 |
| 5a | Fascetta canna per cal. .50 | Forend cap for .50 cal. | Bande du canon pour Cal 50 | 0800002909 |
| 6 | Calcio | Stock | Monture | 0800003463 |
| 6a | Calcio Scout | Stock for Scout model | Monture pour Scout | 0800003435 |
| 6b | Calcio finito | Stock finished | Monture ouvragé | 080003463A |
| 6c | Calcio finito per mod. Scout | Stock finished for Scout model | Monture pour Scout ouvragé | 080003435A |
| 6d | Calcio completo | Stock with spares | Monture complète | 080003463B |
| 6e | Calcio completo per mod. Scout | Stock for Scout mod. with spares | Monture pour Scout complète | 080003435B |
| 6f | Calcio per mod. Scout cal. .50 | Stock for Scout .50 cal. | Monture pour Scout Cal 50 | 0800003537 |
| 6g | Calcio finito per mod. Scout cal. .50 | Stock finished for Scout .50 cal. | Monture pour Scout Cal 50 ouvragé | 080003537A |
| 6h | Calcio completo per mod. Scout cal. .50 | Stock with spares for Scout .50 cal. | Monture pour Scout Cal 50 complète | 080003537B |
| 7 | Ghiera anteriore | Front thimble | Busette antérieure | 0800003021 |
| 7a | Ghiera intermedia per Pennsylvania | Middle thimble for Pennsylvania | Busette intermédiaire pour Pennsylvania | 0800003021 |
| 8 | Copiglia fissaggio ghiera e canna | Rear barrel pin | Goupille pour busette et canon | M70COP5366 |
| 9 | Ghiera posteriore | Rear thimble | Busette postérieure | 0800003017 |
| 10 | Copiglia posteriore fissaggio canna | Rear barrel pin | Goupille postérieure fixation canon | M70COP5220 |
| 11 | Portaluminello | Drum | Porte-cheminée | 0800004206 |
| 11a | Focone | Vent screw | Lumière | 0800002911 |
| 12 | Vite portaluminello | Drum screw | Vis de porte-cheminée | M70TFC5261 |
| 13 | Parafiamma | Fire screen | Pare-feu | 0800004201 |
| 14 | Luminello | Nipple | Cheminée | 0800003407 |
| 15 | Rondella vite cartella | Lock plate screw washer | Rondelle de vis platine | M70RON5848 |
| 15a | Rondella vite cartella per Scout | Lock plate screw washer for Scout model | Rondelle de vis platine pour Scout | M70RON4259 |
| 16 | Vite cartella | Lock plate screw | Vis de platine | M70TFM5535 |
| 16a | Vite cartella cal. .50 | Lock plate screw .50 cal. | Vis de platine Cal 50 | M70TFM5537 |
| 17 | Calciolo | Butt plate | Plaque de couche | 0800002427 |
| 18 | Vite calciolo | Butt plate screw | Vis de plaque de couche | M70LFC5393 |
| 19 | Piastrina calciolo | Toe plate | Platine de plaque de couche | 0800004205 |
| 20 | Vite posteriore guardamano e piastrina | Toe plate and rear trigger guard screw | Vis postérieure pontet et platine de plaque | M70LFC5392 |
| 21 | Sottoguardia | Trigger plate | Sous-garde | 0800004637 |

| Nomenclatura / List / Liste | | | | Codice Reference Référence |
|------------------------------------|--|--|--|---|
| No. | Italiano | English | Français | |
| 21a | Sottoguardia completo | Trigger plate, assembled | Sous-garde complète | 080004637B |
| 22 | Grilletto anteriore | Front trigger | Détente antérieure | 0800003008 |
| 23 | Grilletto posteriore | Rear trigger | Détente postérieure | 0800003009 |
| 24 | Molla grilletto anteriore | Front trigger spring | Ressort de détente antérieure | 0800003614 |
| 25 | Molla grilletto posteriore | Rear trigger spring | Ressort de détente postérieure | 0800003754 |
| 26 | Vite regolazione molla caricam. stecher | Set trigger adjusting spring screw | Vis réglage ressort de double détente | M700ST5308 |
| 27 | Vite molle grilletti | Triggers springs screw | Vis ressorts des détentes | M70TFC5501 |
| 28 | Copiglia grilletto anteriore | Front trigger pin | Goupille de détente antérieure | M70COP5521 |
| 28a | Copiglia grilletto caricamento | Rear trigger pin | Goupille de détente postérieure | M70COP5520 |
| 29 | Vite regolazione stecher | Set trigger adjusting screw | Vis réglage double détente | M70TFC5214 |
| 30 | Guardamano | Trigger guard | Pontet | 0800003012 |
| 31 | Vite anteriore guardamano | Front trigger guard screw | Vis antérieure du pontet | M70TFC5499 |
| 32 | Vite braghetta | Bridle screw | Vis de bride | M70TFM5508 |
| 33 | Vite leva scatto | Sear screw | Vis de gâchette | M70TFM5510 |
| 34 | Braghetta | Bridle | Bride | 0800002207 |
| 35 | Noce | Tumbler | Noix | 0800003903 |
| 36 | Farfallina | Fly | Papillon | 0800002906 |
| 37 | Vite molla leva scatto | Sear spring screw | Vis du ressort de gâchette | M70TFM5214 |
| 38 | Molla leva scatto | Sear spring | Ressort de gâchette | 0800003610 |
| 39 | Leva scatto | Sear | Gâchette | 0800003409 |
| 40 | Cartella a percussione | Percussion lock plate | Platine à percussion | 0800002418 |
| 41 | Cane a percussione | Percussion hammer | Chien à percussion | 0800002404 |
| 42 | Vite cane | Hammer screw | Vis du chien | M70TFC5501 |
| 43 | Molla cane | Mainspring | Grand ressort | 0800003608 |
| 43a | Molla cane per acciarino a pietra | Mainspring for flintlock | Grand ressort pour platine à silex | 0800003753 |
| 44 | Puntale posteriore bacchetta (cal. .32) | Rear ramrod tip (.32 cal.) | Embout postérieur baguette (Cal 32) | 0800004209 |
| 44a | Puntale posteriore bacchetta (.45/.50) | Rear ramrod tip (.45 & .50 cal.) | Embout postérieur baguette (Cal 45/50) | 0800004214 |
| 45 | Bacchetta completa (cal. .32) | Ramrod with tips (.32 cal.) | Baguette complète (Cal 32) | 0800002228 |
| 45a | Bacchetta completa (cal. .45/.50) | Ramrod with tips (.45 cal.) | Baguette complète (Cal 45/50) | 0800002230 |
| 45b | Bacchetta completa Scout (cal. .32) | Ramrod for Scout with tips (.32 cal.) | Baguette complète pour Scout (Cal 32) | 0800002275 |
| 45c | Bacchetta completa Scout (cal. .45/.50) | Ramrod for Scout with tips (.45 & .50) | Baguette complète pour Scout (45/50) | 0800002306 |
| 46 | Puntale anteriore bacchetta (cal. .32) | Front ramrod tip (.32 cal.) | Refouloir (Cal 32) | 0800004215 |
| 46a | Puntale anteriore bacchetta (cal. .45/.50) | Front ramrod tip (.45 & .50 cal.) | Refouloir (Cal 45/50) | 0800004343 |
| 47 | Tenone | Tenon | Tenon | 0800004607 |
| 48 | Tappo canna cal. .45 | Breech plug .45 cal. | Bouchon de culasse Cal 45 | 0800005056 |
| 48a | Tappo canna cal. .50 | Breech plug .50 cal. | Bouchon de culasse Cal 50 | 0800005055 |
| 49 | Cartella a pietra | Flintlock plate | Platine à silex | 0800002417 |
| 50 | Cane a pietra | Flintlock hammer | Chien à silex | 0800002402 |
| 51 | Premipietra | Top jaw | Mâchoire supérieure | 0800004202 |
| 52 | Vite premietra | Top jaw screw | Vis des mâchoires | M70SPC5460 |
| 53 | Martellina | Frizzen | Batterie | 0800002420 |
| 54 | Vite martellina | Frizzen screw | Vis de batterie | M70SPC5449 |
| 55 | Molla martellina | Frizzen spring | Ressort de batterie | 0800003606 |
| 56 | Vite molla martellina | Frizzen spring screw | Vis du ressort de batterie | M70TFC5214 |
| 57 | Tirantino | Stirrup | Chaînette | 0800004892 |
| 58 | Molla bacchetta | Ramrod spring | Ressort de baguette | 0800003655 |
| 59 | Vite molla bacchetta | Ramrod spring screw | Vis du ressort de baguette | M70LFC5384 |